

SPECIAL NOTES

1. All work shown on these plans shall be done in conformity with applicable provisions of Specifications No. 2274.
2. 5" x 4" manholes shown on plan must be constructed on 10" x 5" type of pipe with 12" depth of property line (4.25') to 16" (4.88').
3. 178.85' of Sta. 4' R.C.C. Sidewalk to be const. on 10" St., 0.50' north of the South property line.

GENERAL NOTES

1. All work shown on these plans shall be done in conformity with applicable provisions of Specifications No. 2274.
2. 5" x 4" manholes shown on plan must be constructed on 10" x 5" type of pipe with 12" depth of property line (4.25') to 16" (4.88').
3. House Connection Details shown on plan are approximate and erect locations are to be located in the field.
4. Manhole frame and cover is to be constructed 8" below the official grade, and to be raised by the paving contractor after completion of paving.

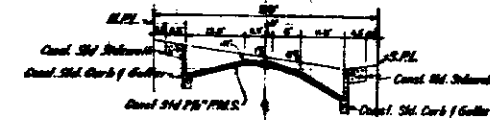

BM Manhole @ 9th Street and Ferris Street
Elev. 1107.47 M.S.L.

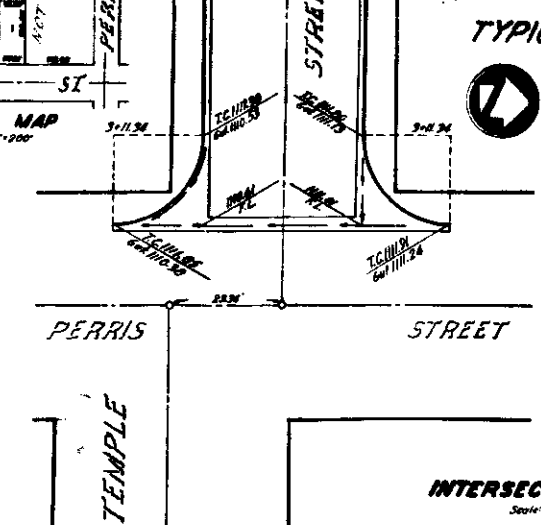
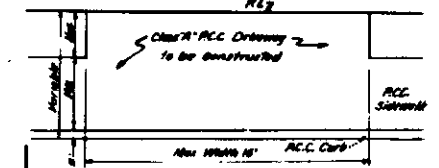
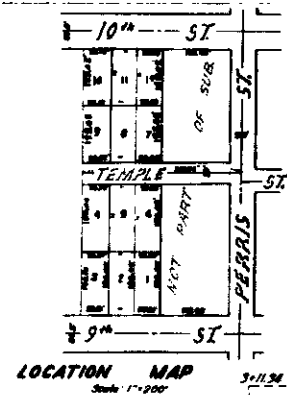
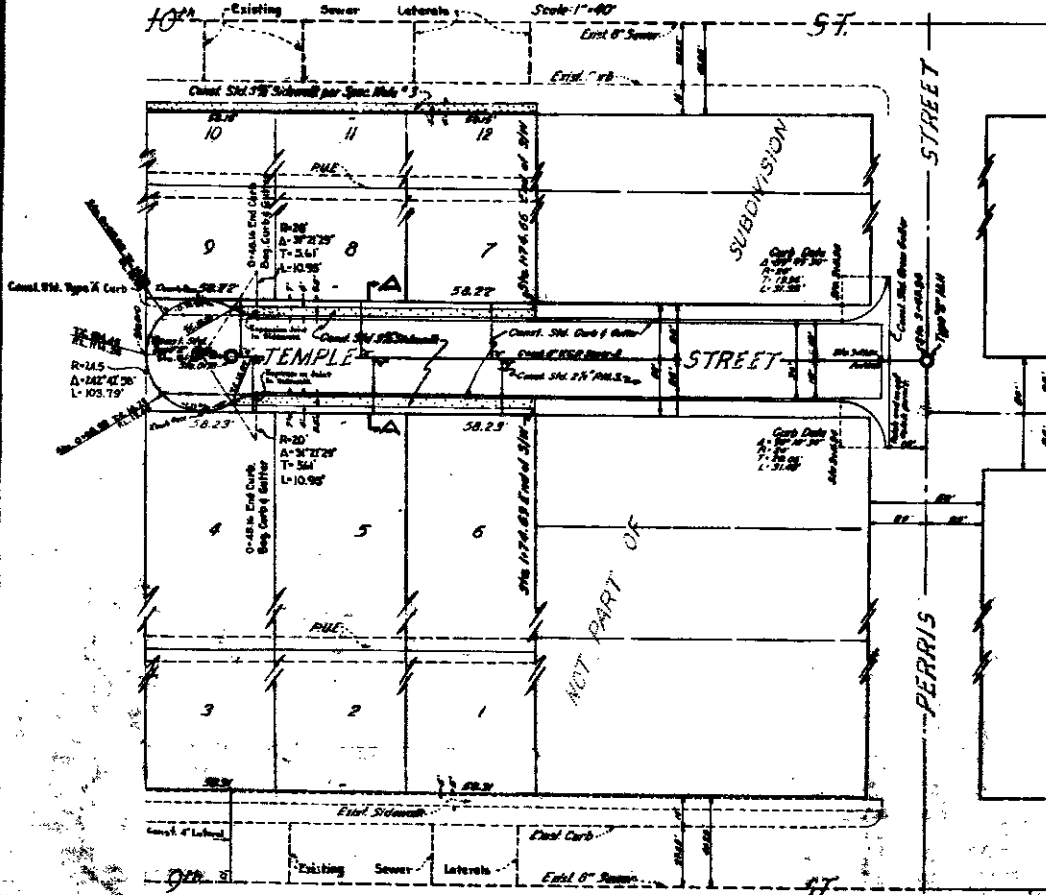

DEPARTMENT OF ENGINEERING
CITY OF SAN BERNARDINO

IMPROVEMENT PLANS
TRACT 5161

APPROVED BY: [Signature]
DRAWN BY: C.L.G.
CHECKED BY: [Signature]

REFERENCE: 2393
SHEET: 1 OF 1